

LEAVEY
EXECUTIVE
CENTER
SANTA CLARA UNIVERSITY

CERTIFIED
EQUITY
PROFESSIONAL
INSTITUTE



Save the date for our 21st
Annual Symposium!
July 22, 2025



21st Annual CEPI and Silicon Valley NASPP Symposium

SANTA CLARA UNIVERSITY
LEAVEY SCHOOL OF BUSINESS
LUCAS HALL

Certified Equity Professional Institute (CEPI)

The CEPI at the Leavey Executive Center is the premier certification body for equity compensation professionals. Offering certification, research, and continuing education, the CEPI is well positioned in the equity compensation industry and has a proven track record of meeting and exceeding the needs of today's equity compensation professionals.



The Silicon Valley NASPP Chapter supports stock plan professionals with resources, education, and community-building. Partnering with the CEPI, a leader in equity compensation certification, we're excited to offer valuable insights and expertise to attendees. Together, NASPP and the CEPI provide unmatched support to the equity compensation industry.



21st Annual CEPI and SV NASPP Symposium

➔ Format

- A dynamic, one-day, in-person event on the SCU campus.
- Experience top-tier educational sessions alongside ample networking opportunities.
- Limited to 300 participants for an intimate and impactful experience.
- Access recorded sessions post-event for ongoing learning.

➔ Geared for Success!

➔ Get in Front of Your Target Audience

➔ Showcase Your Expertise

➔ Stand Out from Competitors

➔ Content

- Four curated sessions featuring 20 expert-led presentations, with five tailored options per session.
- Practical, actionable insights designed to be immediately applicable in your professional role.

➔ Location

- Lucas Hall in the Leavey School of Business at Santa Clara University in Santa Clara, California

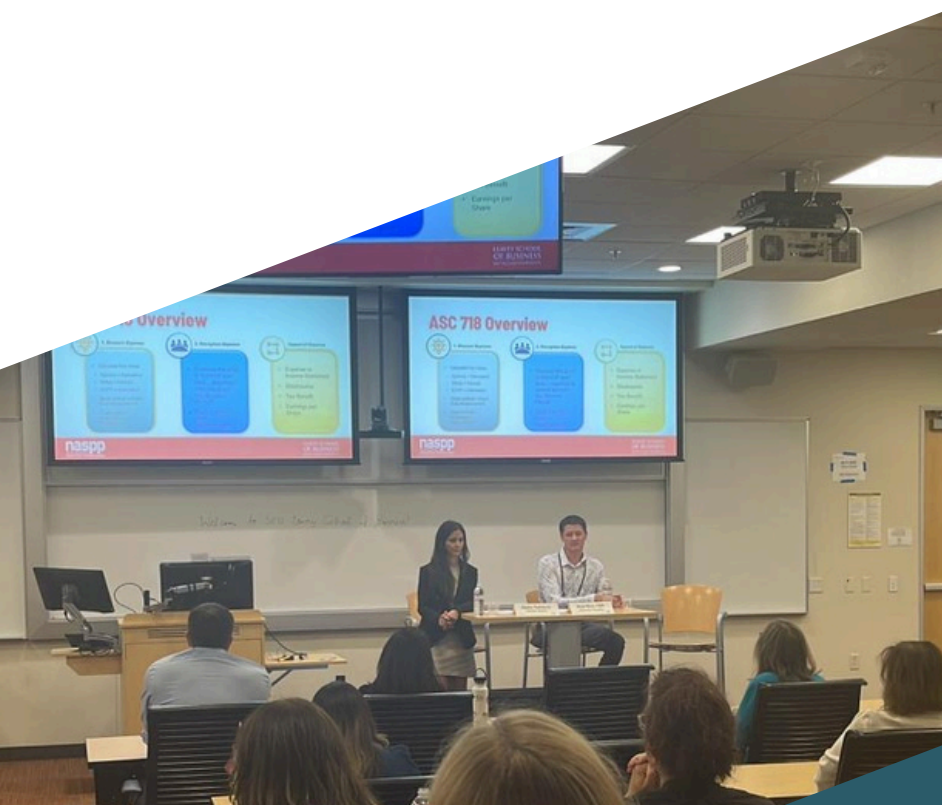

1st Floor

■ Exhibitor Space

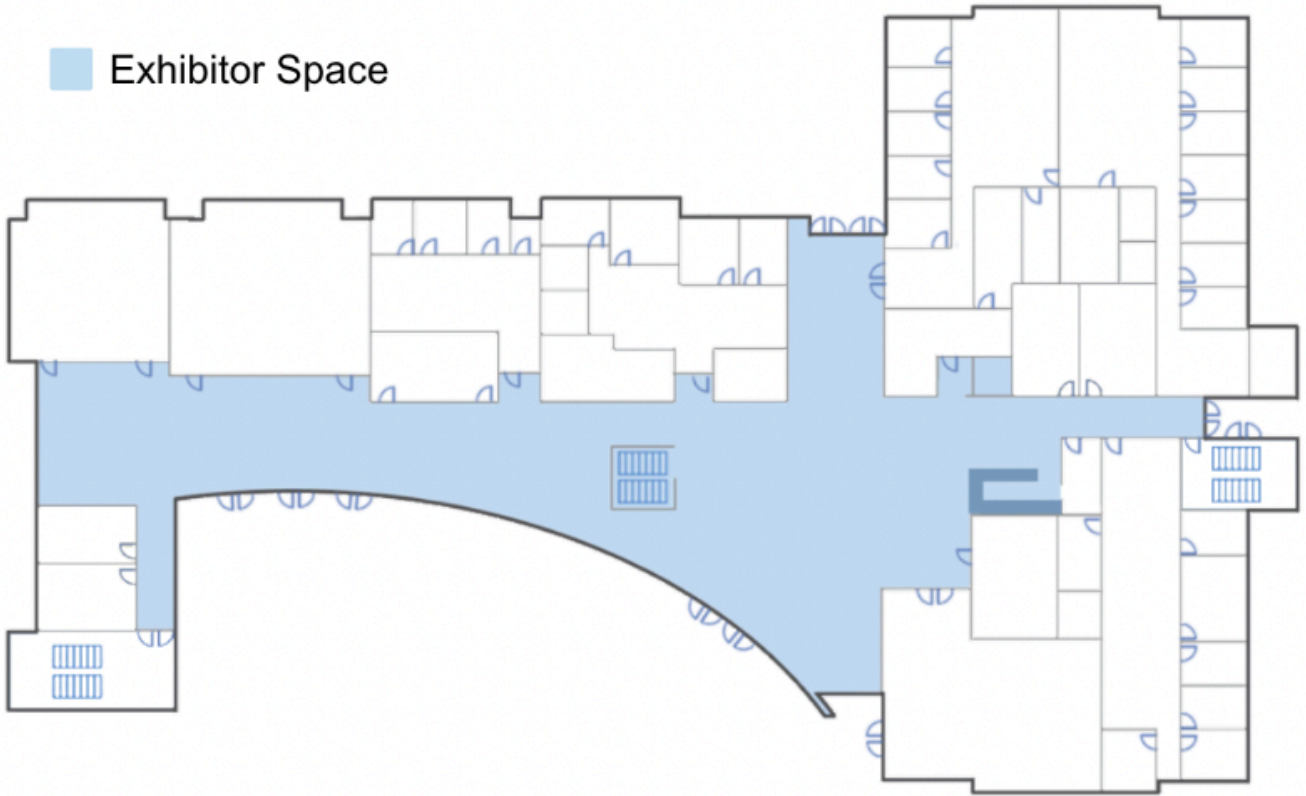

Exhibitor Space



2025 Symposium Sponsorship Packages

➔ Pavilion Level

Premium visibility as a featured sponsor. Access to the attendee registration list for one-time email outreach. (Option to host a private event before or after the Symposium.)

\$8,000

- 10 full-access Symposium passes for client attendees
- 3 limited-access passes for sponsor representatives (exhibitor only)
- Prominent recognition in Symposium communications and on the CEPI website
- Large logo displayed on the sponsor page
- 8' exhibitor table for onsite interaction

➔ Exhibitor Level

A popular choice for impactful event presence. Access to the attendee registration list for one-time email outreach.

\$4,000

- 5 full-access Symposium passes for client attendees
- 2 limited-access passes for sponsor representatives (exhibitor only)
- Recognition in Symposium communications and on the CEPI website
- Medium logo featured on the sponsor page
- 8' exhibitor table for onsite engagement

➔ Supporter Level

Tailored for organizations seeking an affordable opportunity to showcase their brand while maintaining a presence at the event.

\$1,000

- Economical way to support the event
- Includes 2 limited-access Symposium passes for sponsor representatives (exhibitor-only access)
- Acknowledgment in Symposium communications and on the CEPI website.
- Small logo featured on the Symposium sponsor page

Commitment due by May 14, 2025



Email cepi@scu.edu with your sponsorship level interest

Sponsorship	Pavilion: \$8,000	Exhibitor: \$4,000	Supporter: \$1,000
Logo on Sponsorship Page	Large	Medium	Small
8 Foot Exhibitor Table?	Yes	Yes	No
Client Attendee Passes	10	5	0
Exhibitor Passes	3	3	2
\$50 Off Additional Client Passes?	Yes	Yes	Yes

Build Industry Relationships

Increase Brand Recognition

Expand Your Outreach



Contact Us

 <https://www.scu.edu/execed/cepi/>

 cepi@scu.edu